

CITY OF MURRAY CONTROL MONUMENT CARD

DESIGNATION: C6 2010 A
TYPE: 30" POURED CONCRETE MONUMENT W/ CITY DISK
DATE SET: JUNE 2010 QUAD: MURRAY, KY.
HORIZONTAL DATUM: NAD-83 (NSRS 2007)
VERTICAL DATUM: NAVD-88 (GPS) ZONE: KY. S 1602

NORTHING: 1750666.238 FT STATE: KENTUCKY
EASTING: 882179.562 FT COUNTY: CALLOWAY
ELEVATION: 560.15 FT (GPS)
LATITUDE: N 36°36'27.60285" LONGITUDE: W 088°20'00.45372"
SCALE: 1.000025185 CONVERGENCE: -1°34'00.37510"
PLANE AZI. TO AZI. MARK:

To Reach: Located at the intersection of State Route
94W and Doran Rd.

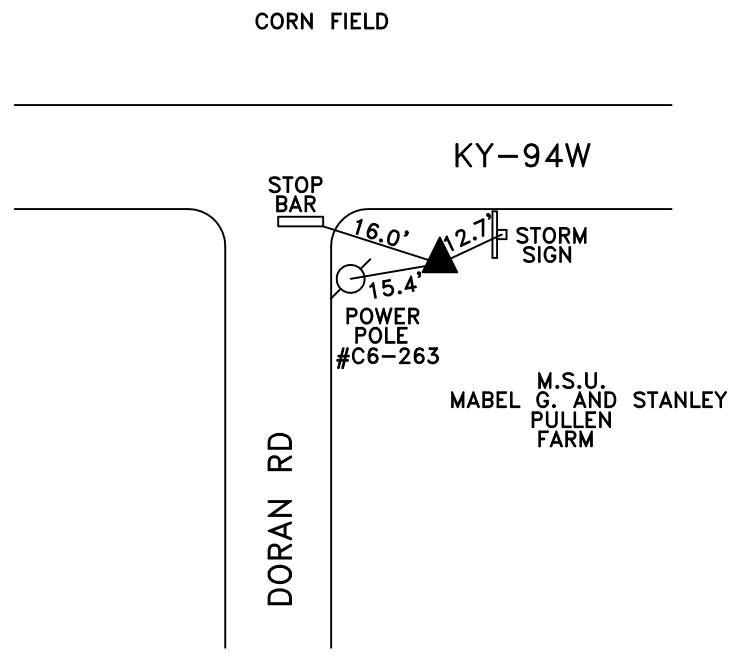

NOT TO SCALE



GRW Aerial Surveys, Inc.
801 Corporate Dr. Lexington Ky. 40503
(859)223-3999